

# MARBLE FIREBOX SUITE

## Installation Guide

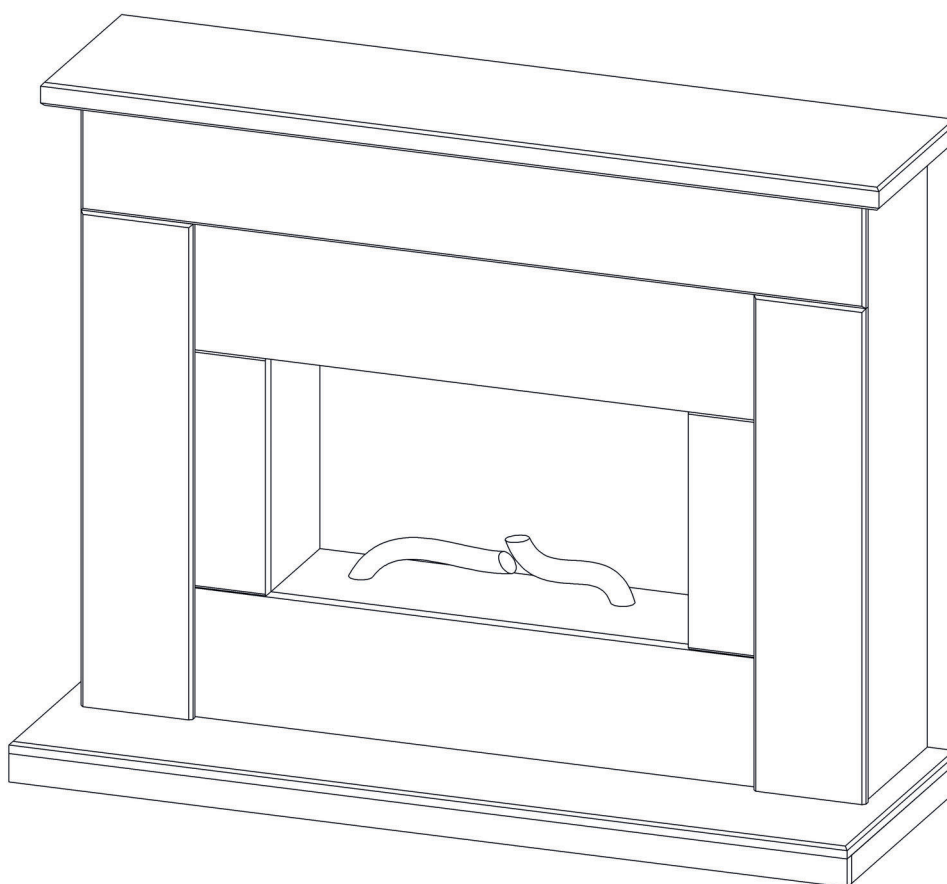

Please read through the use & care manual provided with this product first.

[www.firedupcorporation.com/manual](http://www.firedupcorporation.com/manual)

## PARTS SUPPLIED

- Hearth
- Surround
- Shelf
- MDF Plinth
- Firebox
- Fixing Kit

## TOOLS & PARTS REQUIRED

- Pencil/Pen
- Drill & 6mm Drill Bit
- Silicone / Caulk
- Tape Measure

## Installation

1. Push the hearth against the wall, ensuring it is level and secure.

Measure the distance between the brackets fixed to the shelf.

Using the hearth as a reference, find the centre and measure 765mm upwards, mark this point

Mark the distance of the brackets on the shelf using the centre point and fix the stand off brackets to the wall accordingly.

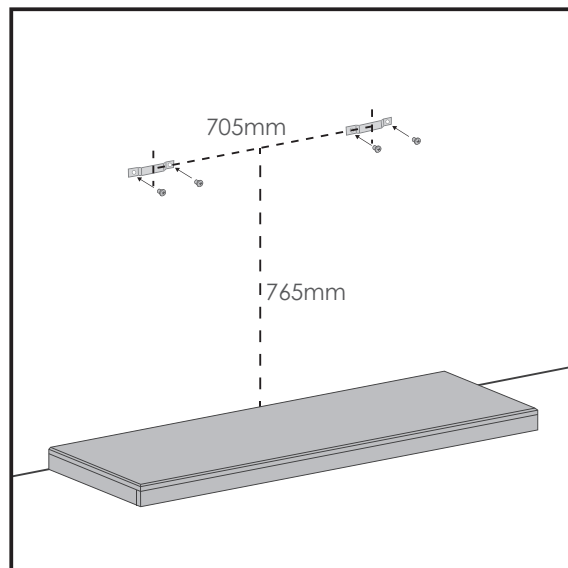

2. Position the fireplace body against the wall, on the hearth and check it is central.

Note: The skirting board can be cut to accommodate the width of the fireplace body to offer a closer fit to the wall.  
(Measure the body and mark the skirting for the correct cut).

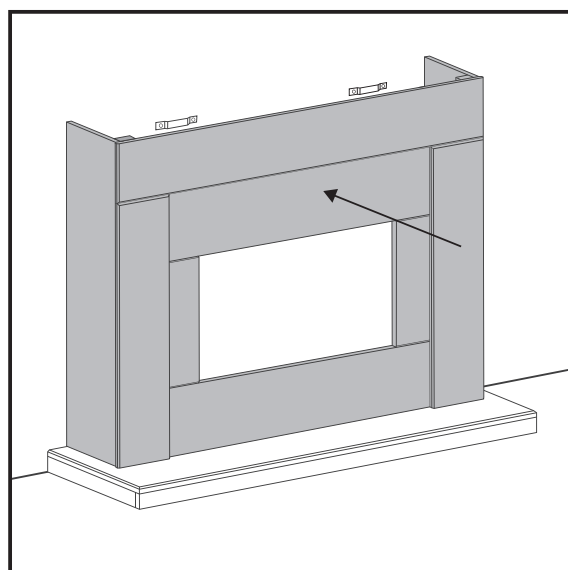

3. Once in position, fix the body to the wall using the anti-topple straps and the brackets provided.

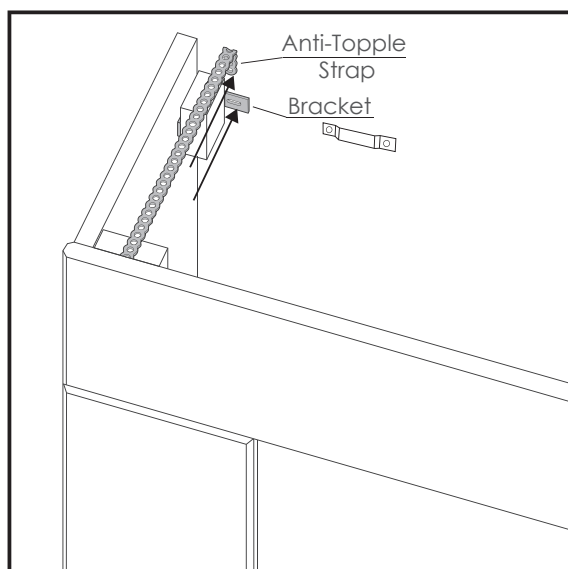

4. Take Firebox out of packaging and remove 4 x screws and hooks.

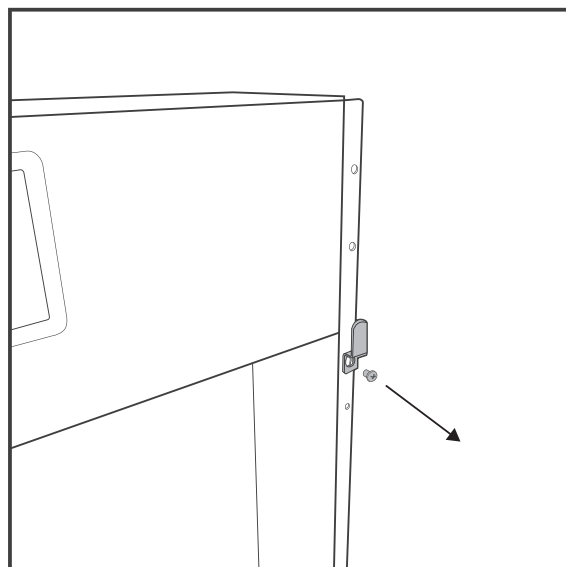

5. Insert MDF plinth into the surround from the top, ensuring it sits central to opening on the front of the surround.

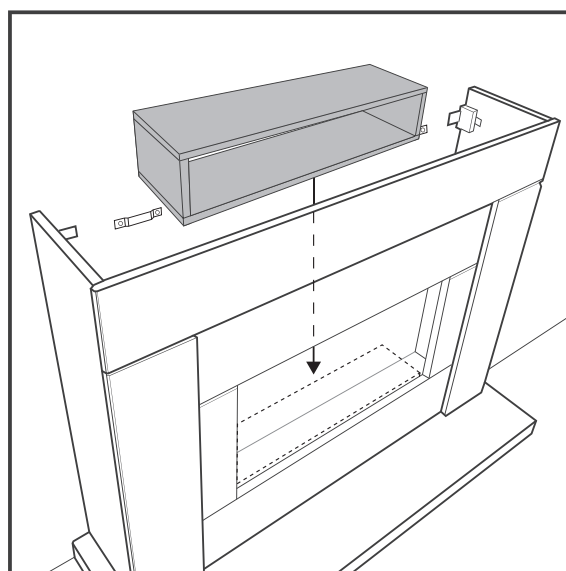

6. Fix the included neoprene strips along the length of the sides and bottom edge of the Firebox and remove the non-stick layer, exposing the adhesive.

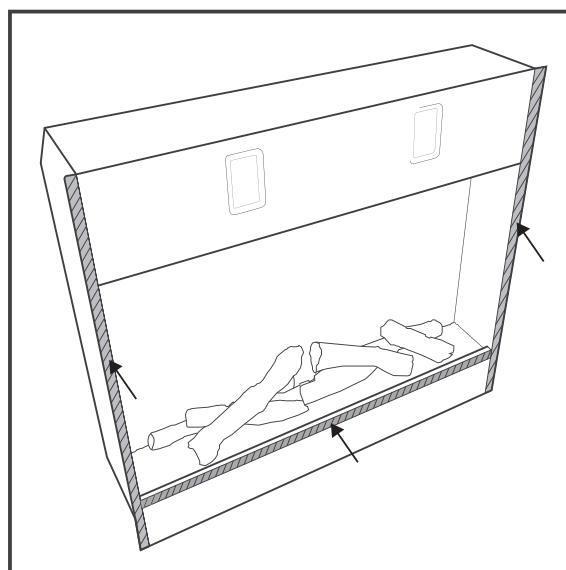

7. With help, lift the Firebox and feed plug into the surround, plugging it in whilst raised off the floor.

Carefully lower the Firebox onto plinth and ensure it is central to the opening.

Once central, push Firebox against back panel to fix it in place.

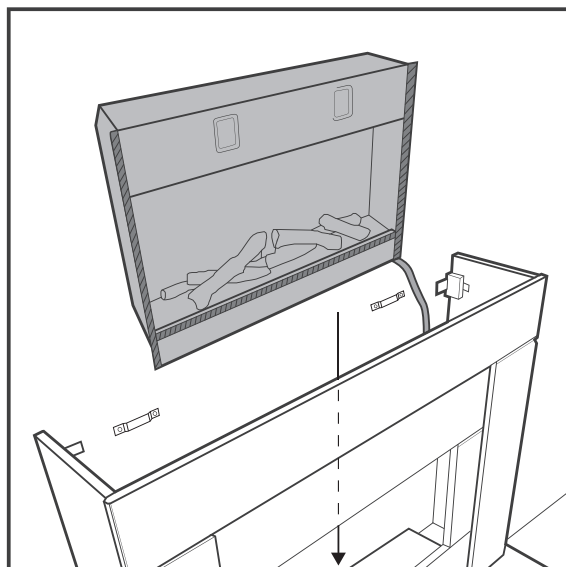

8. Once brackets are in place, apply 3 x "pea sized" dabs of silicone onto the top edge of surround and, with help, lift the shelf and slowly lower onto the surround whilst ensuring hooks go into brackets so the shelf is stable and does not move.

Check shelf is central once lowered onto surround.

